

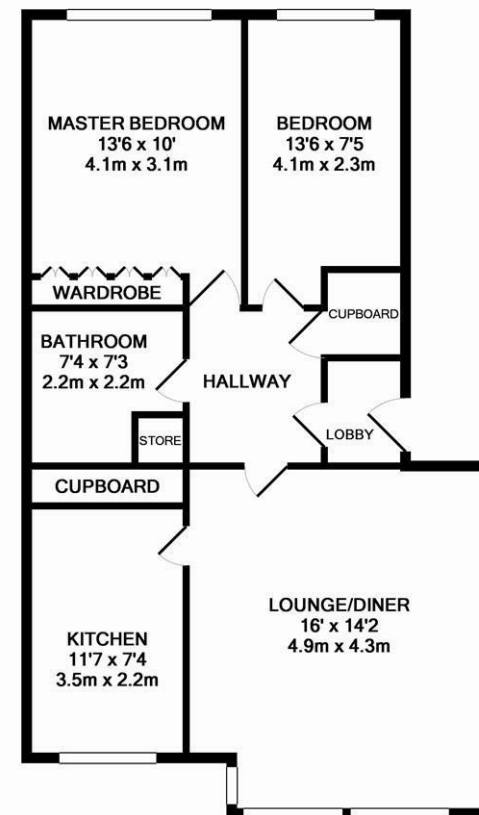

With no onward chain, a stylish first floor apartment, ideally located within Burlington Court, Adderstone Crescent, Jesmond. Tucked behind St George's Church and arguably one of Newcastle's most prestigious residential addresses Adderstone Crescent is perfectly placed to give access to all Jesmond has to offer.

The apartment itself, originally constructed in 1975 boasts almost 700 Sq. ft and briefly comprises a well kept entrance lobby accessed via secure telephone entry system; entrance hallway; 17ft lounge/diner with impressive views out over Jesmond Dene; modern fitted kitchen with granite work surfaces and some integrated appliances; two double bedrooms, bedroom one with fitted wardrobes; bathroom WC. Well presented throughout and with off street parking, including a garage (located next to the main entrance) as well as communal gardens, this great apartment demands an early internal inspection.

First Floor Apartment | 683 Sq. ft (63.5m²)
 | Two Bedrooms | 17ft Lounge/Diner |
 Modern Kitchen | Bathroom WC |
 Communal Gardens | Fantastic Location |
 DG & Electric Heating | No Onward Chain
 | Garage | Council Tax Band: C | Service
 Charge £1,531 Per Annum | Leasehold with
 977 Years Remaining | EPC Rating: E
 (currently under review)



TOTAL APPROX. FLOOR AREA 683 SQ.FT. (63.5 SQ.M.)

Whilst every attempt has been made to ensure the accuracy of the floor plan contained here, measurements of doors, windows, rooms and any other items are approximate and no responsibility is taken for any error, omission, or mis-statement. This plan is for illustrative purposes only and should be used as such by any prospective purchaser. The services, systems and appliances shown have not been tested and no guarantee as to their operability or efficiency can be given
 Made with Metropix ©2015

Offers Over £245,000

Misrepresentation Act 1967. These particulars and the descriptions and measurements herein do not constitute representation and whilst every effort has been made to ensure accuracy, this cannot be guaranteed.

